



*2010 FIRE PREVENTION  
CALENDAR*





## **FIRE SAFETY IN THE HOME**

Preventing fires in your home requires little work. Take a few minutes to inspect your home. As you and your family go from room to room, answer the questions using the checklist below. Discuss each item together and keep your home fire safe.

**“In the event of an emergency, dial 9-1-1”**

### **FIRE SAFETY CHECKLIST**

- |   |     |
|---|-----|
| 1. Are the smoke detectors installed, tested and kept in working condition at all times?                                | Y N |
| 2. Has the family escape plan been rehearsed periodically and kept up to date?  | Y N |
| 3. Are the flammable liquids stored out of reach of children and away from heat sources?                                | Y N |
| 4. Are the space heaters at least three feet from anything that will burn (papers, curtains, furniture, clothes, etc.)? | Y N |
| 5. Are all electrical cords & plugs in good condition? Are they overloaded?   | Y N |
| 6. Are bathroom and kitchen outlets protected by ground-fault circuit interrupters?                                     | Y N |
| 7. Is gasoline stored in the shed or garage? Is it stored in a container approved for gasoline storage?                 | Y N |
| 8. Are matches & lighters kept high, out of the reach of children, preferably locked in a cabinet?                      | Y N |
| 9. Can all of the windows and doors open easily? Are any blocked or obstructed?   | Y N |
| 10. Has the furnace and fireplace been cleaned and inspected during the past year?                                      | Y N |
| 11. Has the lint under the washer & dryer, refrigerator and stove been cleaned?   | Y N |
| 12. Is there a fire extinguisher within easy access to the kitchen area?  | Y N |
| 13. Is the yard kept free of leaves, debris and combustible rubbish?  | Y N |
| 14. Are candles in sturdy, non-tip and non-combustible candle holders?  | Y N |
| 15. Is the stove top and counters clean and uncluttered?  | Y N |
| 16. Are all the lids tightly closed on chemicals, paints & flammable containers?  | Y N |
| 17. Is the stove, oven and the broiler kept clean of grease?  | Y N |
| 18. Is the water heater thermostat at 120* (or lower) to prevent scalds and burns?                                      | Y N |
| 19. If you employ a babysitter, do they know what to do in case of a fire?  | Y N |
| 20. Do the children know how to call 9-1-1, and know their address?   | Y N |

### **FIRE FACTS**

- Each year thousands of Americans die and approximately 20,000 are injured in fires, many of which could have been prevented.
- **Fire is fast!** In less than thirty seconds a small flame can get completely out of control and turn into a major fire.
- Most fires occur in the home at night, when people are asleep. You won't have time to grab your valuables, there is only time to get out.
- **Fire is hot!** Room temperature in a fire can be 100 degrees at the floor level and 600 degrees at eye level.
- **Fire is dark!** Fire starts bright, but quickly produces thick, black smoke and complete darkness. This is why it is important to know your escape plan.
- **Fire is deadly!** The smoke and toxic gases produced in a fire kill more people than flames do.

***In the event of a fire, remember every second counts!***

# JANUARY 2010

## MICHIGAN FIRE INSPECTOR SOCIETY

SUN	MON	TUE	WED	THU	FRI	SAT	NOTES
					 <b>1</b>	<b>2</b>	
<b>3</b>	<b>4</b>	<b>5</b>	<b>6</b>	<b>7</b>	<b>8</b>	<b>9</b>	
<b>10</b>	<b>11</b>	<b>12</b>	<b>13</b>	<b>14</b>	<b>15</b>	<b>16</b>	
<b>17</b>	<b>18</b>	<b>19</b>	<b>20</b>	<b>21</b>	<b>22</b>	<b>23</b>	
<b>24</b>	<b>25</b>	<b>26</b>	<b>27</b>	<b>28</b>	<b>29</b>	<b>30</b>	
<b>31</b>							

***SPONSOR'S NAME AND NUMBER***

***SPONSOR'S NAME AND NUMBER***



# SMOKE DETECTORS

Smoke detectors play a vital role in reducing deaths and injuries due to fires in the home. Sixty-five percent of home fire deaths occurred in homes with no smoke detectors or no working smoke detectors. Properly installed and maintained smoke detectors saves lives and protect against injury and loss due to fire.

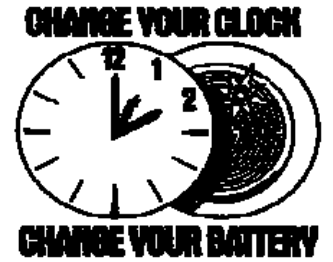

- Install working smoke detectors according to manufacturer’s instructions near each sleeping area, on each level of your home and in each bedroom for optimum protection.
- Clean and test your smoke detector each month. Regularly vacuuming or dusting your smoke detector can keep them working properly.
- If your smoke detector is 10years old or older, it’s time to replace it.
- Change your smoke detector battery twice every year. Change your clock, change your battery.
- Change your battery immediately if the smoke detector “chirps” to indicate a low battery.
- Do not disable your smoke detector if it alarms due to cooking or other non-fire causes. Instead clear the air by waving a towel near the alarm, leaving the batteries in place.
- Make sure your whole family knows what the alarm sounds like and what to do in the event of an alarm.
- **NEVER** “borrow” a battery from a smoke detector. Smoke Detectors can’t warn you if their batteries are missing or have been disconnected.

## Smoke Detector Facts

- *The fire death rate in homes with working smoke detectors is 51% less then the rate for homes without protection.*
- *Why do smoke detectors fail? Most often because of missing, disconnected or dead batteries. Nuisance activations were the leading cause of disabled smoke detectors.*
- *It is necessary to practice home fire drills to be certain everyone is familiar with the smoke detector signal sound and to determine if there are any obstacles to a quick and safe evacuation (including for the inability for some to awaken to the smoke detector signal).*

Q S A V E S L I V E S W E R T B A T T E R I E S A S D F  
 D G E Q C Y H J H F X T W I C E A Y E A R L O P R C U  
 F A M I L Y B I D F W K H F L P O I T R E W S N T G R  
 B E T S F X J F I R E F I G H T E R S J H F G T Y U I S A  
 L A R M A N D C H I R P S T R E Y R V N J K O M E V  
 B J F Y R E S A X R S M O K E D E T E C T O R S F N A  
 T E S T M O N T H L Y F Q W X V H K U I P O L M G R  
 B T R E J E R V R W P R E V E N T S I N J U R I E S E A  
 C H L E V E L O F T H E H O M E R E W O P M L I W T

Find the following words in the puzzle:

- Smoke detectors
- Batteries
- Twice a year
- Test monthly
- Saves lives
- Prevents injuries
- Each level of the home
- Fire fighters
- Alarm and chirps
- Family
- Maintain



FIRE LINE - DO NOT CROSS

# FEBRUARY 2010

## MICHIGAN FIRE INSPECTOR SOCIETY

SUN	MON	TUE	WED	THU	FRI	SAT	NOTES
	 <b>1</b>	<b>2</b>	<b>3</b>	<b>4</b>	<b>5</b>	<b>6</b>	
<b>7</b>	<b>8</b>	<b>9</b>	<b>10</b>	<b>11</b>	<b>12</b>	<b>13</b>	
<b>14</b>	<b>15</b>	<b>16</b>	<b>17</b>	<b>18</b>	<b>19</b>	<b>20</b>	
<b>21</b>	<b>22</b>	<b>23</b>	<b>24</b>	<b>25</b>	<b>26</b>	<b>27</b>	
<b>28</b>							

MFIS SAMPLE COPY 2008, Copyright MFIS 2008 ©

MFIS SAMPLE COPY 2008, Copyright MFIS 2008 ©

***SPONSOR'S NAME AND NUMBER***

***SPONSOR'S NAME AND NUMBER***

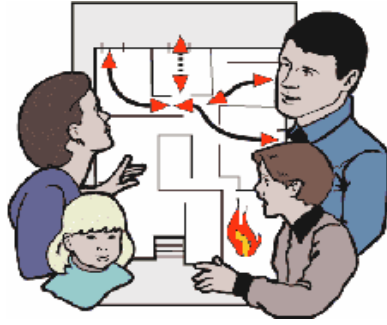

## E.D.I.T.H.

### (EXIT DRILLS IN THE HOME)

What would you do if there was a fire in your home? Fires can be loud, burn very fast and make a room or home very dark. It helps to have a plan and for everyone to know what to do. It's important to get out fast and a good escape plan can do that. It is best to have two ways out of every room and stay low. The most important part of the plan is to know it and **PRATICE** it.

**9-1-1** FIRE  
POLICE  
MEDICAL

1. Try to find two ways out of every room in your home. The first way out should be the door. Every way needs to be planned and practiced.
2. Before opening a door, feel the door with the back of your hand from the bottom up including the door handle. If the door is hot, there may be fire on the other side. Try to get out another way.
3. Stay low when escaping a fire. Heat and smoke rises during a fire. The safest air is down low.
4. If you have safety bars on your windows, make sure you know how to open them in case you need to escape.
5. Have a safe and easy-to-remember place outside to meet your family after you get out.
6. After you get out, call 9-1-1 or the fire department.
7. Stay outside no matter what and never go back inside for anything.
8. Your plan should be practiced every six months.
9. Teach all family members how to dial 9-1-1. State your name, location & type of emergency.
10. Teach all family members how to **Stop Drop and Roll** if their clothes were to catch on fire.

In a typical house fire, people have about 2 minutes to get outside. It is easy to become confused and panic in that short of time, especially children. During a fire, children will often try to hide under their bed or in a closet because that's where they feel safe rather than getting outside. This is why it is important to make a fire escape plan and everyone practice it together.

## Stop Drop and Roll

Stop Drop and Roll is a simple fire safety technique taught to extinguish a fire on a person's clothes or hair. The technique consist of three components:

1. **STOP** – the victim must cease all movement which may fan the flames. Do not run, this will cause the flames to spread.
2. **DROP** – the victim must drop to the ground and lay down, covering their face. If fire is on their arms, they should lay down with their arms to their side.
3. **ROLL** – the victim rolls like a log in an effort to extinguish the fire by depriving it of oxygen.

**"NEVER HIDE – GET OUTSIDE"**



**KNOW WHEN  
TO GO!**  
**REACT  
FAST TO FIRE!**





## Fire Safety Tip & Facts Page

- Avoid running extension cords under carpets and across doorways.
- Repair or replace loose, frayed or damaged cords on all electrical devices immediately.
- Homes with small children should use plastic safety covers in unused outlets and extension cord ends.
- Avoid overloading wall outlets and extension cords. Have a qualified electrician install additional outlets if extension cords are needed for a long period of time.
- When buying electrical appliances look for products which meet the Underwriters Laboratory (UL) standard for safety.
- December is the most dangerous month for electrical fires. Fire deaths are highest in the winter months because of more indoor activity, increased lighting, heating and appliance use. Most electrical wiring fires start in the bedroom.



- Never leave the stove unattended while cooking. If you must leave, turn the stove off.
- Keep the stove top and counter space free of anything that can catch fire and free of clutter.
- Have a “Kid Free Zone” of at least 3 feet around the stove and areas where hot food is prepared.
- Do not wear loose fitting clothes while cooking. Loose clothing can come into contact with the stove burners and catch fire.
- Have a fire extinguisher in the kitchen area easily accessible.
- Children should not cook alone or without asking an adult.
- You may extinguish a grease fire on the stove by placing a lid on the pan or a large amount of baking soda. Once it is extinguish, don't forget to turn off the burner.
- **NEVER** put water on a grease fire! Water will splatter the grease and dramatically increase the size of the fire.
- **NEVER** try to carry a flaming grease fire outside. It will quickly be too hot to carry and you could certainly spread fire all over the entire area.

## HOME SPRINKLER SYSTEMS

*Commercial buildings benefit from fire sprinkler systems, why not your home? Smoke detectors can alert the occupant of a fire in the home...it cannot contain or extinguish a fire. Residential sprinklers can!*

- *The installation of residential sprinklers can save thousands of lives, prevent injuries and eliminate millions of dollars in property losses.*
- *Homes can be built or retrofitted to include low-cost fire protection connected directly to the domestic water supply.*
- *Residential sprinklers will assure a safer environment for your family, protect your investment and irreplaceable family possessions.*
- *Homeowner's insurance will vary depending on coverage. Discounts now range between 5-15% in premiums.*
- *Firefighters will have less risk of injury or loss of life since they will be fighting a fire of less intensity.*
- *Families with children, senior citizens, and handicapped members have special fire protection needs. Residential sprinkler systems provide added protection for these people.*



**MICHIGAN ARSON PREVENTION**  
**REWARD** UP TO **\$5,000**  
1-800-44-ARSON

### ARSON FACTS

- 25%-40% of all fires are set by children.
- More than 70% of all fires in vacant or abandoned buildings are incendiary or suspicious.
- Arson is the leading cause of dollar loss from fire, exceeding \$2 billion annually.
- 61% of all school fires are caused by arson.
- 1 out of every 4 fires are caused by ARSON.
- Arson is the second leading cause of residential fire deaths. Only topped by smoking.



**MICHIGAN ARSON PREVENTION**  
**REWARD** UP TO **\$5,000**  
1-800-44-ARSON

**ARSON AWARENESS**  
**ARSON IS NOT A VICTIMLESS CRIME!**

*Arson - is the willful or malicious burning of property.*

FIRE LINE - DO NOT CROSS - FIRE LINE - DO NOT CROSS - FIRE LINE - DO NOT CROSS

**ARSON - A word that should strike fear into all of us. It signifies destruction, devastation, and death. Arsonists deliberately set fire for profit, hate, revenge and thrills. Arson is a major criminal activity. Arson is an epidemic that robs our communities.**



### Steps that can reduce incidents of arson:

- Contact your local police / fire department if you know or suspect an arson crime.
- Report suspicious activities near homes or buildings. Support your *Neighborhood Watch* programs.
- Keep leaves and flammable debris away from buildings. Don't make it easy for an arsonist to start a fire or facilitate a fire's



**Arsonists often escape punishment but citizens can do their part by helping provide information about these crimes.**

**MICHIGAN ARSON PREVENTION**  
**REWARD** UP TO **\$5,000**  
1-800-44-ARSON

### Vehicle Arson Prevention

- Park your vehicle in a well-lit area.
- Use a secured parking lot for extended periods.
- Close and lock all windows, doors, trunk and tailgates.
- Remove the keys from the ignition.
- Use anti-theft devices.
- Do not keep your valuables visible.
- Report abandoned vehicles to the police.



**MICHIGAN ARSON PREVENTION**  
**REWARD** UP TO **\$5,000**  
1-800-44-ARSON

# MAY 2010

## MICHIGAN FIRE INSPECTOR SOCIETY

SUN	MON	TUE	WED	THU	FRI	SAT	<b>NOTES</b> _____ _____ _____ _____ _____ _____ _____ _____ _____ _____ _____
						 <b>1</b>	
<b>2</b>	<b>3</b>	<b>4</b>	<b>5</b>	<b>6</b>	<b>7</b>	<b>8</b>	
<b>9</b>	<b>10</b>	<b>11</b>	<b>12</b>	<b>13</b>	<b>14</b>	<b>15</b>	
<b>16</b>	<b>17</b>	<b>18</b>	<b>19</b>	<b>20</b>	<b>21</b>	<b>22</b>	
<b>23</b>	<b>24</b>	<b>25</b>	<b>26</b>	<b>27</b>	<b>28</b>	<b>29</b>	
<b>30</b>	<b>31</b>						

MFIS SAMPLE COPY 2008, Copyright MFIS 2008 ©

MFIS SAMPLE COPY 2008, Copyright MFIS 2008 ©

***SPONSOR'S NAME AND NUMBER***

***SPONSOR'S NAME AND NUMBER***

**EMERGENCY  
DIAL 9-1-1**

# SUMMERTIME SAFETY



## S.A.F.E

Before your children head out to the playground, check that:

- Keep barbecue grills away from anything that will burn, such as your home, cars, and dry vegetation.
- For charcoal grills, only use starter fluid designed for barbeque grills; **NEVER** use gasoline.
- Never grill/barbeque in enclosed areas - carbon monoxide could be produced.
- When using a propane grill, check all of the connections & fuel lines before cooking.
- Dispose of your coals properly - douse with water and stir them up.
- Do not add fluid to an already lit fire, the flames can flashback into the container and explode.



- Buy a bike that is the right size, not one that your child will "grow into". Oversized bikes are especially dangerous.
- When purchasing a helmet, make sure it has the CPSC safety standard label affixed to it.
- A helmet should be worn at all times. Remember that wearing a helmet at all times helps the child to develop the helmet habit.
- A helmet should be worn so that it is level on the head. The strap should be securely fastened and you should not be able to move the helmet in any direction.



- Build campfires where they will not spread, away from dry grass and leaves.
- Keep campfires small and don't let them get out of hand.
- Keep plenty of water and a shovel around to douse the fire when you are done. Stir it and douse it again.
- **NEVER** leave a campfire unattended.
- **NEVER** use gasoline on a campfire.



- **Pools should have a fence at least 4 feet high around all 4 sides.**
- **The gates should open outward from the pool area and be self closing & self latching at a height children can not reach.**
- **Keep rescue equipment around the pool such as life preserver, a long pole with a hook on the end and telephone.**
- **Remember that "floaties" are not a substitute for approved life vests and can give a child a false sense of security.**
- **Whenever infants or toddlers are in or around water, an adult should be within arm's length, providing "touch supervision".**
- **Swim program for children under 4 years of age should not be seen as a way to decrease the risk of drowning.**
- **NEVER run or horseplay around a pool or open waters.**
- **Learn CPR (cardiopulmonary resuscitation) - it can be a lifesaver when seconds count!**



**Summer time is a fun time for everyone. Just remember to think safety first and be smart!**



**Don't forget the sunscreen !!**



- **Supervision - Watch for potential hazards and observe. Strings on clothing and ropes used for play could cause accidents if caught on equipment.**
- **Age appropriate equipment - Children are developmentally different and require different equipment. Ensure your child is in the correct area of the playground.**
- **Falls - 70% of all playground injuries are due to falls. Surfaces should not be rocks, concrete, asphalt, or blacktop.**
- **Equipment - Check to make sure all playground equipment is secured, all pieces in working order, S-hooks are fastened, equipment is safe to play on.**

**HAVE FUN!**



# JUNE 2010

## MICHIGAN FIRE INSPECTOR SOCIETY

SUN	MON	TUE	WED	THU	FRI	SAT	<b>NOTES</b> _____ _____ _____ _____ _____ _____ _____ _____ _____ _____ _____ _____ _____ _____ _____
		 <b>1</b>	<b>2</b>	<b>3</b>	<b>4</b>	<b>5</b>	
<b>6</b>	<b>7</b>	<b>8</b>	<b>9</b>	<b>10</b>	<b>11</b>	<b>12</b>	
<b>13</b>	<b>14</b>	<b>15</b>	<b>16</b>	<b>17</b>	<b>18</b>	<b>19</b>	
<b>20</b>	<b>21</b>	<b>22</b>	<b>23</b>	<b>24</b>	<b>25</b>	<b>26</b>	
<b>27</b>	<b>28</b>	<b>29</b>	<b>30</b>				

***SPONSOR'S NAME AND NUMBER***

***SPONSOR'S NAME AND NUMBER***

MFIS SAMPLE COPY 2008, Copyright MFIS 2008 ©

MFIS SAMPLE COPY 2008, Copyright MFIS 2008 ©



# FIREWORKS SAFETY

## MICHIGAN FIREWORKS LAW

**Fireworks means a device made from explosive or flammable compositions used primarily for the purpose of producing a visible or audible effect, or both, by combustion, deflagration, or detonation.**

### **LEGAL FIREWORKS (NO PERMIT REQUIRED)**

- Flat paper caps
- Toy trick noise makers (party poppers, pop-its, fun snaps, toy pistols using flat paper caps, ect.)
- Flitter sparklers (a narrow paper tube attached to a thin wooden handle producing shower of sparks)
- Fountains that are cone-shaped or cylindrical-shaped that emits a shower of sparks and sometimes a whistle effect
- Toy snakes (a pressed like pellet that produces a large snake-like ash upon burning)
- Toy smoke devices (smoke bombs, smoke pots, smoke balls - devices that emit a white or colored smoke)
- Signal flares, blank cartridges, or blank cartridge pistols, and railroad emergency signal devices
- The sale of fireworks provided they are to be shipped directly out of state (dealers selling fireworks in Michigan using signed statements that the purchaser will use the fireworks out of state is prohibited!).

**Fireworks which do not fit among above exceptions are illegal for sale, use or transportation without permit.**

## HOW MUCH DO YOU KNOW ABOUT FIREWORKS?

Take the quiz...each answer is either true or false

1. Children should never play with or light fireworks.
2. Adults should always keep a bucket of water handy in case of a malfunction or fire.
3. Adults should read and follow all warning labels and instructions before using a device.
4. Adults should make sure that other people are out of the way before lighting fireworks.
5. Sparklers burn at such high temperatures that could burn clothing.
6. A 7-year old boy lost his left hand, including his fingers when he lit an M-80 he found hidden in a family bedroom.
7. An 8-year old girl received second and third degree burns to her leg when a spark from a sparkler she was holding ignited her dress.

Answers: All of the above are TRUE.

## Fireworks facts

- More fires are reported on July 4th then any other day of the year, fireworks account for half of those fires.
- 95% of the fireworks injuries treated in hospitals involved fireworks that Federal regulations permit consumers to use.
- Nearly half of ALL people injured by fireworks are under the age of 15.
- Fireworks cause thousands of structure fires, hundreds of vehicle fires, thousands of injuries and millions of dollars of fire damage...every year!!
- Body parts most injured by fireworks:
  - \* Hands / fingers 31%
  - \* Eyes 25%
  - \* Head / face 20%
- More then half of the injuries were burns or injuries leading to blindness, 3rd degree burns and permanent scarring.

*The safest way to prevent fireworks related injuries is to leave the fireworks displays to the trained professionals!*



## Novelty Lighters

Toy-like or novelty lighters have been responsible for fires, injuries, deaths and accidents across the nation. Children are attracted to novelty lighters because they look like toys, with visual effects, flashing lights and musical sounds. Some local and State governments are taking action by banning the sale of novelty lighters and limiting their distribution. Novelty lighters are dangerous and even deadly in the hands of children.

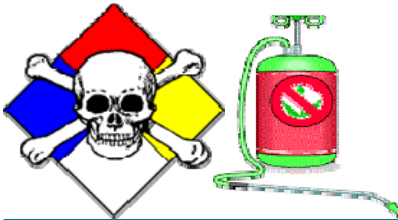

## HOUSEHOLD HAZARDOUS MATERIALS

A typical home contains dozens of products that can harm human health or the environment. These products are used in cleaning, home improvement, automobile maintenance, lawn and garden care, hobbies, and many other tasks. Each year, thousands of people are injured by exposure or accidents involving household materials.

- Store only a small amount of gasoline in an approved container outside of the home and NEVER use gasoline inside the home.
- Keep gasoline out of children's sight and reach. Children should never handle gasoline.
- Read all of the labels of the products in your home. If the label has the words "Warning", "Caution", "Poison" or "Danger", keep out of reach of the children, and lock them up.
- Have child safety caps on all chemicals, medications and cleaning products. Keep all products in original containers with the original labels on them. Dispose of any outdated products properly.
- Household chemicals and waste enters our land, water and air during use or improper disposal. Many cities and county's have Household Hazardous Material or Waste Programs that will assist in the proper disposal.
- Call the **Poison Control Help number 1-800-222-1222**, if you have any questions about poisons.

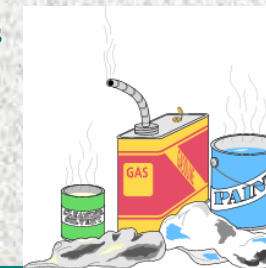

Each year careless smokers start more than 25,000 home fires. Those fires have caused death and millions of dollars in property loss.

- USE Large, deep non-tip ashtrays and empty them often.
- DONT walk away from lit cigarettes and other smoking materials.
- BE RESPONSIBLE and keep your lighters & matches out of reach from children. Children as young as two years old are capable of lighting cigarette lighters and matches.
- MAKE SURE when you put it out, it is really out.
- DON'T light up if you need to lie down. Despite the risk of falling asleep and setting the bed or couch on fire, people are still smoking in bed.

Always check to see that cigarettes are extinguished before emptying ashtrays. Stubs that are still burning can ignite trash.

**EVERY YEAR CHILDREN DIE FROM STARTING FIRES WITH CIGARETTES AND LIGHTERS...**

**THEY SHOULDN'T HAVE!**

# AUGUST 2010

## MICHIGAN FIRE INSPECTOR SOCIETY

SUN	MON	TUE	WED	THU	FRI	SAT	NOTES
 <b>1</b>	<b>2</b>	<b>3</b>	<b>4</b>	<b>5</b>	<b>6</b>	<b>7</b>	
<b>8</b>	<b>9</b>	<b>10</b>	<b>11</b>	<b>12</b>	<b>13</b>	<b>14</b>	
<b>15</b>	<b>16</b>	<b>17</b>	<b>18</b>	<b>19</b>	<b>20</b>	<b>21</b>	
<b>22</b>	<b>23</b>	<b>24</b>	<b>25</b>	<b>26</b>	<b>27</b>	<b>28</b>	
<b>29</b>	<b>30</b>	<b>31</b>					

***SPONSOR'S NAME AND NUMBER***

***SPONSOR'S NAME AND NUMBER***

## Scald Prevention

*A scald is an injury caused by hot liquids or steam. Each year, injuries and death occur due to scalding from excessively hot tap water. The majority of these incidents involve older adults and children under five.*

- Set your water tank at 120 degrees F or just below the medium setting.
- Test the water before your children get in the tub and watch them closely.
- Keep hot drinks away from the edges of tables and counters so children can't reach them.
- Keep children away from the stove while cooking, use heavy pot holders and turn the pot handles toward the back of the range. Test the heated or micro-waved food before feeding young children.
- Treat minor burn injuries immediately with cool running water for 3-5 minutes. Do not apply ice, which can cause further harm. Apply sterile bandage to the injured area and seek medical treatment if scald is serious.

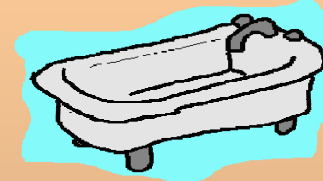

### *Basic Burn Treatment*

Stop, Drop and Roll if your clothes catch on fire, no matter how young or old and cover your face.

Cool the burn immediately with cool water to stop the burning process. **DO NOT USE** ice on burns this could actually make the burn worse.

Remove the burnt clothes. Loosen or remove tight clothing. You may have remote swelling away from the burn.

After cooling the burn with water, cover the burn with a clean dressing. If none available, use a clean t-shirt. Don't use a towel because the fibers may stick in the wound and will be painful to remove.

Keep the burn victim warm.

**Get medical help!  
Never underestimate the  
seriousness of a burn.**

### BURN PREVENTION TIPS

*There are three important steps parents can take to prevent children from playing with matches and lighters.*

- **Educate** - teach your children that there is a difference between “tools” that only grown-ups use and “toys” that are safe for children to play with. Teach them to TELL a grown-up if they find matches or lighters.
- **Supervise** - children are curious and will imitate adults. If they witness an adult lighting birthday candles, lighting the grill or lighting a campfire, they may just want to “surprise you” and do it themselves.
- **Storage** - it is important to keep matches and lighters stored up high and out of reach of children. Children are curious and can find them in drawers, end tables, nightstands and that are left in pockets.



THE FIRE EXTINGUISHER TO THE RIGHT ...IS A NOVELTY LIGHTER!!

**Have your child point to each picture and tell you if it is a “Tool” or “Toy”. Explain to your child that tools are only to be used by adults:**



# SEPTEMBER 2010

## MICHIGAN FIRE INSPECTOR SOCIETY

SUN	MON	TUE	WED	THU	FRI	SAT	<b>NOTES</b> _____ _____ _____ _____ _____ _____ _____ _____ _____ _____ _____
			 <b>1</b>	<b>2</b>	<b>3</b>	<b>4</b>	
<b>5</b>	<b>6</b>	<b>7</b>	<b>8</b>	<b>9</b>	<b>10</b>	<b>11</b>	
<b>12</b>	<b>13</b>	<b>14</b>	<b>15</b>	<b>16</b>	<b>17</b>	<b>18</b>	
<b>19</b>	<b>20</b>	<b>21</b>	<b>22</b>	<b>23</b>	<b>24</b>	<b>25</b>	
<b>26</b>	<b>27</b>	<b>28</b>	<b>29</b>	<b>30</b>			

MFIS SAMPLE COPY 2008, Copyright MFIS 2008 ©

MFIS SAMPLE COPY 2008, Copyright MFIS 2008 ©

***SPONSOR'S NAME AND NUMBER***

***SPONSOR'S NAME AND NUMBER***

## Halloween Safety Tips

- Purchase costumes and props labeled flame-resistant or flame retardant.
- Purchase costumes that are bright and reflective and fit properly.
- Provide children with flashlights to carry or as part as their costume.
- Remember to keep exits clear of decorations ensuring nothing blocks the egress.
- Use caution when using candles in jack-o-lanterns and be sure to place pumpkins away from anything that will burn. Consider using battery operated candles.
- Remind your children not to eat the treats until they have been inspected properly.
- This is a great time to buy new, fresh batteries for your home smoke alarms!

### WOOD STOVES

- Wood stoves need to be installed to existing building codes and manufacturer's instructions.
- The chimney and stovepipe have to be frequently checked for creosote buildup and cleaned when necessary.
- The stove has to sit on a code-specified listed floor protector which is non-combustible.
- All combustibles such as curtains, drapes, chairs etc., have to be at least 3 feet away from the stove.



### KEROSENE HEATERS

- Only 1-K kerosene is used in heaters. Buy from a dealer who can certify that the product is 1-K kerosene.
- Do not place the heater in the path of egress such as doorways and hallways.
- Kerosene should be stored outdoors and out of the reach of children in a tightly sealed, preferably blue or metal container labeled "Kerosene".
- Use in a well ventilated room and turn off while sleeping. Never leave a heater unattended.
- Never use gasoline! Even a small amount of gasoline mixed with kerosene could cause a fire or explosion.



### SPACE HEATERS

- Never place heaters on the furniture, since they may fall and keep all combustibles 3 feet way.
- Unless specified for the purpose, never use heaters in wet or moist places.
- Do not hide extension cords under rugs or carpet. Placing anything on top of the cord could cause it to overheat and can cause a fire.
- Do not use the heater to dry wet clothing, shoes and coats. Never leave the heater unattended.

### CANDLE SAFETY



- ~ Keep candles at least 12 inches away from anything that will burn.
- ~ Use sturdy, safe candle holders that will not tip or burn and are large enough to collect dripping wax.
- ~ Extinguish candles when you leave a room. Never leave a candle unattended.
- ~ Be careful not to splatter wax when extinguishing a candle.
- ~ Avoid using candles in sleeping areas and bedrooms.
- ~ Always use a flashlight, not a candle for emergency lighting.
- ~ Consider using battery operated flameless candles.
- ~ Trim candle wicks to one-quarter inch.



# OCTOBER 2010

## MICHIGAN FIRE INSPECTOR SOCIETY

SUN	MON	TUE	WED	THU	FRI	SAT	NOTES
					 <b>1</b>	<b>2</b>	
<b>3</b>	<b>4</b>	<b>5</b>	<b>6</b>	<b>7</b>	<b>8</b>	<b>9</b>	
<b>10</b>	<b>11</b>	<b>12</b>	<b>13</b>	<b>14</b>	<b>15</b>	<b>16</b>	
<b>17</b>	<b>18</b>	<b>19</b>	<b>20</b>	<b>21</b>	<b>22</b>	<b>23</b>	
<b>24</b>	<b>25</b>	<b>26</b>	<b>27</b>	<b>28</b>	<b>29</b>	<b>30</b>	
<b>31</b>							

***SPONSOR'S NAME AND NUMBER***

***SPONSOR'S NAME AND NUMBER***



# FIRE EXTINGUISHERS



Portable fire extinguishers can save lives and property by putting out small fires but they do have limitations. Fires will grow and spread rapidly, the number one priority is for residents to get out safely. The operator must know how to use the extinguisher, the extinguisher must be in working order & fully charged, match the type of fire being fought and the operator **MUST** have a clear escape route that will not be blocked.

- Choose an extinguisher that carries the label of a testing laboratory.
- Read the instructions and know how to use it before a fire breaks out.
- Install the extinguisher near an exit and keep your back to the exit in case you need to escape and the fire cannot be controlled.
- If the room fills with smoke, leave immediately.
- For the home, select a multi-purpose extinguisher (it can be used on all types of home fires) that is large enough to put out a small fire, but not too difficult to handle.

To operate a fire extinguisher, remember the word **PASS**:

- **P**ull the pin and hold the extinguisher with the nozzle pointing away from you and release the locking mechanism.
- **A**im low. Point the extinguisher at the base of the fire.
- **S**queeze the lever slowly and evenly.
- **S**weep the nozzle from side-to-side.

## TYPES OF FIRE EXTINGUISHERS



**CLASS A:** Used for ordinary combustibles such as wood, paper, cardboard and most plastics.

**CLASS B:** Used for fires involving flammable or combustible liquids such as gasoline, kerosene, grease and oils.

**CLASS C:** Used for fires involving electrical equipment, such as appliances, wiring, circuit breakers and outlets. Never use water to extinguish class C fires. This could cause an electrical shock!

**CLASS D:** Used for fires involving combustible metals, such as magnesium, titanium and potassium. Commonly found in a chemical laboratory.

## Know when to go!

*Extinguishers are one of the key elements in a response plan, but the primary element is a safe escape.*

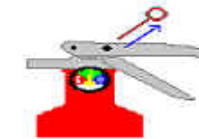

Pull the Pin



Aim to the base of the fire

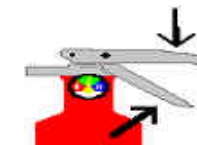

Squeeze the handle



Sweep side to side

# NOVEMBER 2010

## MICHIGAN FIRE INSPECTOR SOCIETY

SUN	MON	TUE	WED	THU	FRI	SAT	NOTES	
	 <b>1</b>	<b>2</b>	<b>3</b>	<b>4</b>	<b>5</b>	<b>6</b>		
<b>7</b>	<b>8</b>	<b>9</b>	<b>10</b>	<b>11</b>	<b>12</b>	<b>13</b>		
<b>14</b>	<b>15</b>	<b>16</b>	<b>17</b>	<b>18</b>	<b>19</b>	<b>20</b>		
<b>21</b>	<b>22</b>	<b>23</b>	<b>24</b>	<b>25</b>	<b>26</b>	<b>27</b>		
<b>28</b>	<b>29</b>	<b>30</b>						

***SPONSOR'S NAME AND NUMBER***

***SPONSOR'S NAME AND NUMBER***

### CHRISTMAS TREES

- The needles should be green and not break off. A dried out tree is a fire hazard. Tap the base of the tree on the ground to see if needles fall from the branches.
- Don't place a tree too close to a heat source, including a vent or fireplace. The heat will dry out the tree causing it to be more easily ignited by heat, flames or sparks.
- Do not put a live tree up too early. Keep the tree stand filled with water at all times.
- Never put needles or branches in a fireplace or wood burning stove, dispose of your tree by recycling or a community pick-up service.
- If you are using an artificial tree, make sure it is flame retardant.
- NEVER place lit candles on a Christmas tree.
- Make sure your lights are not frayed or worn and are approved by a certified testing laboratory.
- Do not add more lights than recommended by the manufacturer. This may pose a potential fire hazard.
- Always unplug your Christmas tree before going to bed.
- Place your tree out of the way of traffic and never block a door or your pathway out.

# SEASONS GREETINGS!

## TURKEY FRYER SAFETY

**Underwriters Laboratory does not certify turkey fryers based on the fire reports related to the use and test findings.**

- Always use outdoors and away from buildings and any materials that can burn. Never use on wooden decks or in garages!
- Make sure the fryer is on a flat surface to prevent tipping.
- Never leave unattended. Most fryers do not have thermostat controls if you don't watch the fryer carefully, the oil will continue to heat up and start a fire.
- Do not overfill the fryer with oil and use oven mitts when touching pot lids.
- Make sure the turkey is completely thawed. Oil and water don't mix, water causes oil to spill over, causing a fire or even an explosion hazard.
- Even after use, never allow children or pets near the turkey fryer. The oil inside the cooking pots remains dangerously hot, hours after use.



## Holiday Safety Tips

- **DO NOT PLUG IN MORE THEN 3 STRANDS OF LIGHTS UNLESS THE DIRECTIONS INDICATE IT IS SAFE.**
- **ALL DECORATIONS SHOULD BE FLAME RETARDANT OR NONFLAMMABLE AND PLACED AWAY FROM HEAT SOURCES.**
- **NEVER THROW WRAPPING PAPER IN THE FIREPLACE. EMBERS COULD CAUSE A CHIMNEY FIRE OR THE WRAPPING MAY IGNITE SUDDENLY CREATING A FLASH FIRE.**
- **DO NOT OVERLOAD ELECTRICAL CIRCUITS, SUCH AS WALL OUTLETS AND EXTENSION CORDS, USE A LISTED CIRCUIT STRIP.**
- **USE CAUTION WITH SMALL CHILDREN IN THE HOME. DECORATIONS COULD BE SHARP OR BREAKABLE. KEEP SMALL REMOVABLE PARTS OUT OF THE REACH OF CHILDREN TO AVOID SWALLOWING OR INHALING.**

FROM THE MICHIGAN  
FIRE INSPECTOR'S FAMILIES  
TO YOUR'S  
HAPPY HOLIDAYS



# DECEMBER 2010

## MICHIGAN FIRE INSPECTOR SOCIETY

SUN	MON	TUE	WED	THU	FRI	SAT	NOTES
			 <b>1</b>	<b>2</b>	<b>3</b>	<b>4</b>	
<b>5</b>	<b>6</b>	<b>7</b>	<b>8</b>	<b>9</b>	<b>10</b>	<b>11</b>	
<b>12</b>	<b>13</b>	<b>14</b>	<b>15</b>	<b>16</b>	<b>17</b>	<b>18</b>	
<b>19</b>	<b>20</b>	<b>21</b>	<b>22</b>	<b>23</b>	<b>24</b>	<b>25</b>	
<b>26</b>	<b>27</b>	<b>28</b>	<b>29</b>	<b>30</b>	<b>31</b>		

***SPONSOR'S NAME AND NUMBER***

***SPONSOR'S NAME AND NUMBER***



## After the Fire... What to do

The following checklist serves as a quick reference and guide for you to follow after a fire strikes.

1. Contact your local disaster relief service, such as The Red Cross, if you need temporary housing, food and medicines.
2. If you are insured, contact your insurance company for detailed instructions on protecting the property, conducting inventory and contacting fire damage restoration companies. If you are not insured, try contacting private organizations for aid and assistance.
3. Check with the fire department to make sure your residence is safe to enter. Be watchful of any structural damage caused by the fire.
4. The fire department should see that utilities are either safe to use or are disconnected before they leave the site. **DO NOT** attempt to reconnect utilities yourself.
5. Conduct an inventory of damaged property and items. Do not throw away any damaged goods until after an inventory is made.
6. Try to locate valuable documents and records.
7. If you leave your home, contact the local police department to let them know the site will be unoccupied.
8. Begin saving receipts for any money you spend related to fire loss. The receipts may be needed later by the insurance company and for verifying losses claimed on income tax.
9. Notify your mortgage company of the fire.
10. Check with an accountant or the Internal Revenue Service about special benefits for people recovering from fire loss.

The safety information and facts in this calendar are only the beginning. There are many tips and preventive measures you can take to help keep yourself and family safe from fire and danger. Taking the time to learn is no effort at all. Having working smoke detectors and knowing what to do in the event of a fire is the most important. We would like to thank all our sponsors that contributed to the making of this calendar. With their support and beliefs in the importance of fire prevention and education, this calendar is possible! The Michigan Fire Inspectors Society encourages you to visit these websites to learn more. Call or visit your local fire department for further information on fire safety:

- Michigan Fire Inspectors - [www.mfis.org](http://www.mfis.org)
- Michigan Bureau of Fire Services -
- International Association of Arson Investigators - Michigan Chapter - [www.michiganiaai.org](http://www.michiganiaai.org)
- Michigan Arson Prevention Committee - [www.miarsonprevention.org](http://www.miarsonprevention.org)
- Michigan Fire Service Coalition - [michiganfireservicecoalition.org](http://michiganfireservicecoalition.org)
- Michigan Association of Fire Chiefs - [www.michiefs.org](http://www.michiefs.org)
- Michigan Professional Fire Fighters Union - [www.mpffu.org](http://www.mpffu.org)
- Michigan State Firemen's Association -
- Metropolitan Detroit Fire Inspectors -
- Oakland County Fire Prevention Society - [www.ocfps.org](http://www.ocfps.org)
- Macomb County Fire Prevention Society - [www.mymcfpa.com](http://www.mymcfpa.com)
- National Fire Protection Association - [www.nfpa.org](http://www.nfpa.org)
- Federal Emergency Management Agency - [www.fema.gov](http://www.fema.gov)
- U.S. Consumer Product Safety Commission - [www.cpsc.gov](http://www.cpsc.gov)
- U.S. Fire Administration - [www.usfa.dhs.gov](http://www.usfa.dhs.gov)

MFIS Sample 2008